

## FILTER INSTALLATION INSTRUCTIONS

Always refer to owner's manual for detailed installation instructions

### OIL FILTERS

1. Unscrew oil filter and clean mounting base. Apply film of clean oil to filter gasket. Do not use grease.
2. Screw new filter on until gasket reaches base. Then tighten according to instructions on filter using tightening guide markers.
3. Add oil, idle engine for five minutes and check for leaks. Then add oil to "full" on dipstick.

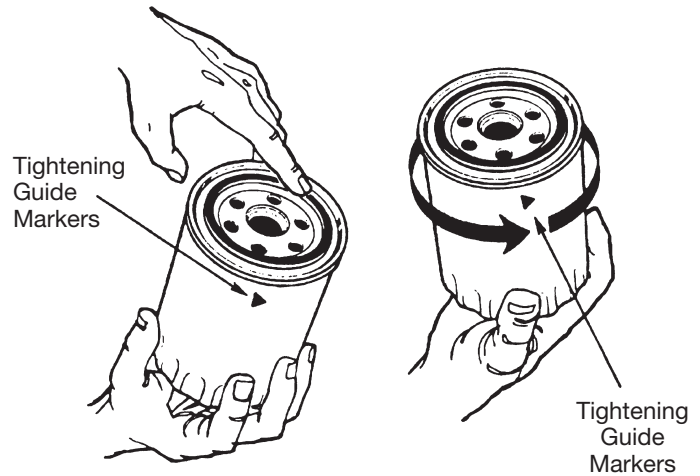

### AIR FILTERS

1. Loosen wing nut or other fasteners to remove filter cover.
2. Remove old air filter. Clean filter cover and housing.
3. Install new air filter. Replace cover and fasten.

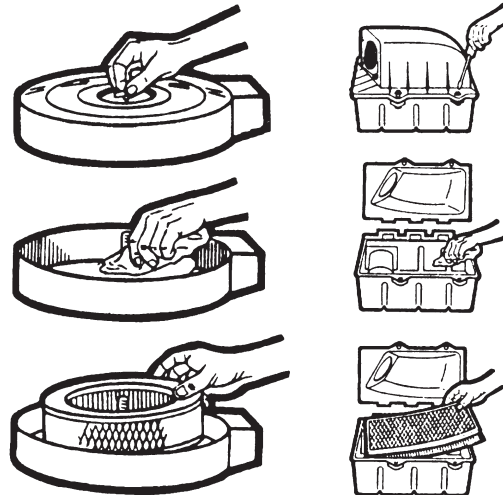

### FUEL FILTERS

1. Check to be sure the proper fuel filter is being installed.
2. When replacing the fuel filter, be sure there are no open fires in the area.
3. **Some fuel systems are pressurized even after the engine is shut down. It is important that the system be depressurized before attempting to replace the fuel filter. See instructions in service manual on depressurizing fuel system.**
4. When servicing the fuel system or changing the fuel filter it is important that you follow the instructions in the service manual.
5. After fuel filter installation, run the engine and check for leaks.